

DESCRIPTION OF PARTS

FLEXY LED-FLEX-MODUL, 300 LED, 5050 RGB+W 3000K,
6 SMD RGB + Warm White per section
60 LED/m
Self-adhesive backing

TECHNICAL DATA

FLEXY1-300RGBW = RGB+W 3000K
SMD LED, 24V, 14,4W/m, 60LED/m, CRI80, IP20

Length: 5m = 50 segments à 100mm | 300 LED = 50 segments à 6 LED | are cuttable after each segment

Width: 12 mm

LAMP

SMD-LED
The LED light agent cannot be replaced.



Protection class III



Notification of Risks



CE label



Safety Instructions



The light can be used in interiors and exteriors.



Cleaning Instructions



The product may not be disposed of in the household garbage.



Don't look directly into the LED! The LED is that bright that it might damage your eyes!



Installation only by qualified and authorised persons.



Do not expose product to heat source



ESD protection component



Not recommended for children under 3 years

DISPOSAL

The packaging consists of environmentally friendly materials. Dispose of them in the local recycling containers.



Do not dispose of this product in the household garbage when it has reached the end of its lifecycle, but rather take it to a disposal center. Your local officials will provide you with information about collection offices and their business hours.

SAFETY



READ THE INSTRUCTIONS BEFORE USING THIS PRODUCT. KEEP THE SAFETY AND OPERATING INSTRUCTIONS FOR FUTURE USE.



- The flexy stripe is only suitable for indoor use (dry and closed rooms).
- Before mounting, the intended splice must be thoroughly cleaned (free from dust, oil and grease layers).
- Assembly only on suitable carrier material, for example Aluminum regarding heat conduction as well as reliable adhesion of the adhesion foil.



- Don't install under power.
- Follow the instruction manual for installation.
- Installation only by qualified and authorised persons.
- Do not use the product when it has been damaged (defective covers) or there are operational faults such as flickering, smoking, steaming, crackling noises or the smell of smoke.
- A damaged or defective product must be changed or repaired by the manufacturer, a service person or a comparable qualified person.
- Installation only under observance of the valid guidelines specific to application and country among others VDE 0.100.
- Never open one of the electrical operating agents or plug any objects into them. Such procedures signify a danger to life through electrical shock.



- Absolutely avoid contact between the product and water or other liquids. For reasons of electrical safety, the light may not be placed in contact with water or other liquids or submerged in water.



- The product may not be changed or modified.
- Keep the remote and its components out of the reach of children. There is a risk of swallowing the batteries inside the remote control. Do not leave packaging material lying around carelessly, there is danger of suffocation. The LED remote control and the controller is not a toy for kids!
- Risk of injury for children! If children or persons who can not assess the dangers use the LED control, there is a risk of injury!
- The warranty claim and guarantee is rendered invalid in the event of damage to the product, which is caused by not following the operating instructions. We are not liable for the consequent damage. Because of specific characteristics of LED's (life, deviation in colour etc.) we formulated special terms for planing and installing our LED products. They are part of these installation manual! Should they not be available, request them please!



- Don't look directly into the LED! The LED is that bright that it might damage your eyes!
- Storage temperature: -40+80°C
- Processing temperature: +10°C (glue)
- Operating temperature in operation: -25+60°C

MAINTENANCE AND CLEANING

The LED light agent cannot be replaced.



- Do not use solvents, such as benzene and similar agents. The flexy stripe would be damaged thereby.
- Only use a dry, lint-free cloth for cleaning the product.

FLEXY1-300 RGBW CRI80

Flexible LED-stripe

FLEXY1-300RGBW



INTENDED USAGE

This product will only serve the purpose of illumination. The LED-stripe can be used in interiors.

SCOPE OF DELIVERY

1 x ESD packaging, content, flexy stripe 5m
1 x set of instructions for assembly, operation and safety

address | contact

A.L.S. GmbH
Mastorter Str. 31 | 88069 Tettnang (Germany)
Tel.: +49 (0) 75 42 93 44-0 | Fax.: +49 (0) 75 42 93 44-30
E-Mail: info@als.de | Web: www.als.de

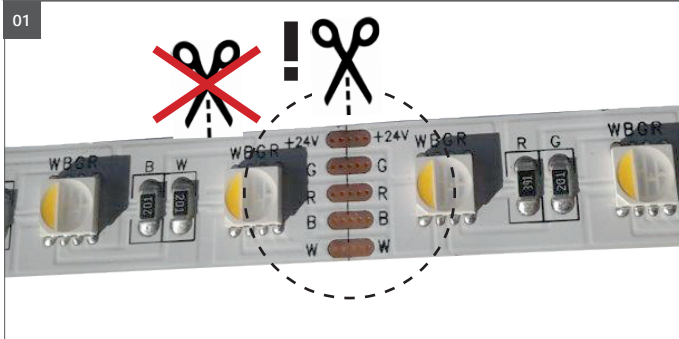

Assembly instructions



Turn Off power supply before starting any installation.
Do not connect the device under power.

Another installation / assembly / materials / types than provided in the manual sheets, release us from any electrotechnical and electrostatic responsibility.

It is recommended that this product is installed by a qualified electrician.

The mounting surface must be smooth, clean and dry, free of grease, oil, dust, silicones. The flexy strip components can not be glued-mounted on sharp-edged edges. During assembly, do not exert excessive pressure on the LED components! Ensure adequate cooling with suitable aluminum mounting rails.

01. The flexy stripe can only be shortened and / or re-applied at the (see picture) contact points. Never cut between the LED components, this section will be destroyed otherwise.
No gluing at right angles around edges, no tight radii and no kinking.

Only use suitable controllers to control the Flexy RGBW stripe.

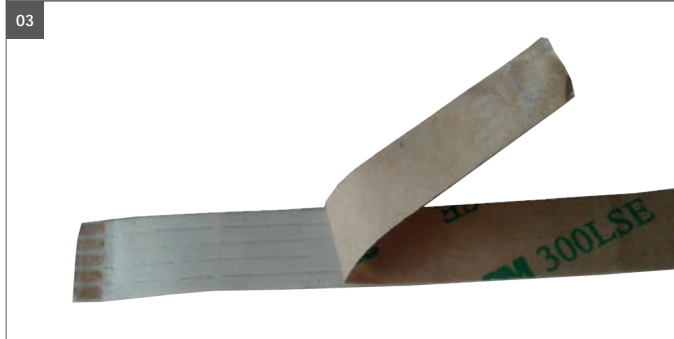
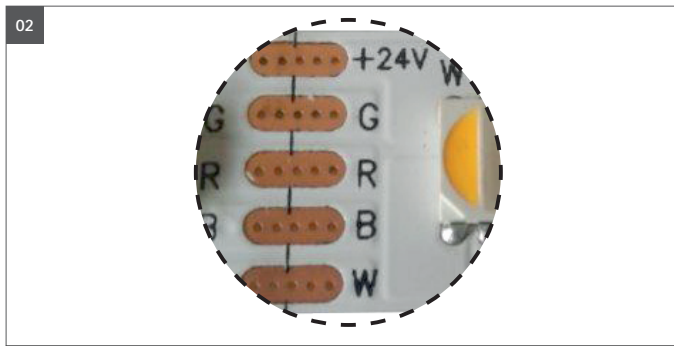

02. Connections (do not wire the wrong way!)

+24V from converter/ LED driver

G = LED green

R = LED red

B = LED blue

W = LED warm white

For soldering, use only lead-free solder and suitable soldering stations, pay attention to the soldering temperature. Take precautions according to the ESD regulations.

Do not make any changes or soldering operations on the LED components!

Note: When extending the flexy stripe to full power, the converter LED output should not be overloaded.

03. For gluing, carefully pull off the protective tape, the adhesive surface on the back should not be touched with the fingers.

Glue the LED Flexy strip to the cleaned rail / surface with light pressure.

Do not use extra sharp adhesives such as super glue, double sided foam tape, this will hinder the heat dissipation to the carrier material.

The flexy tape must not be exposed to additional heat sources.

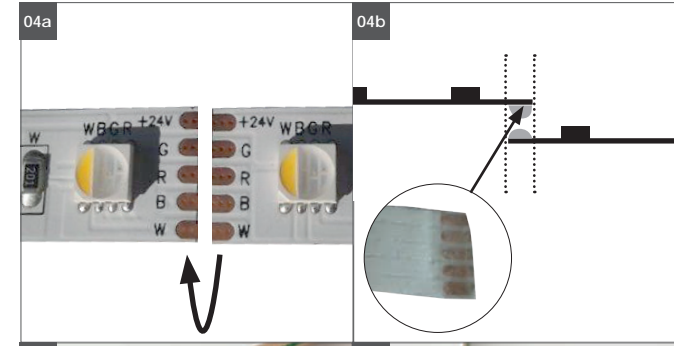

04a. Segments can be connected by soldering of a bridge. Solder up the upper soldering point (**pict. 04b**) with the lower point. Soldering points become visible as soon as protection foil is taken off. Don't take off the foil completely as not to lose the adhesive power of FLEXY. **Attention!** Maximum 5m of Flex strip can be installed with one feeder. For more, additional feeding is required.

05. Minimum radius of bending 6 cm.

06. Do not bend, bending will damage the conductors.



Matching controller for FLEXY1-300RGBW	
Z-FBFLEXYRGBW	X max 200W
CAS-LRGBW 4 Kanal/ Dim	X max 144W

